

SPARRMANSBACKE
 SITUATIONSPLAN
 20230511

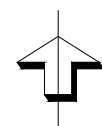

SKALA 1:500

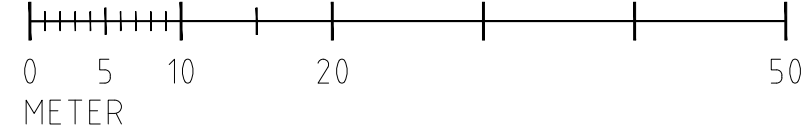

Inkom till Stockholms stadsbyggnadskontor - 2023-09-06, Dnr 2021-14117

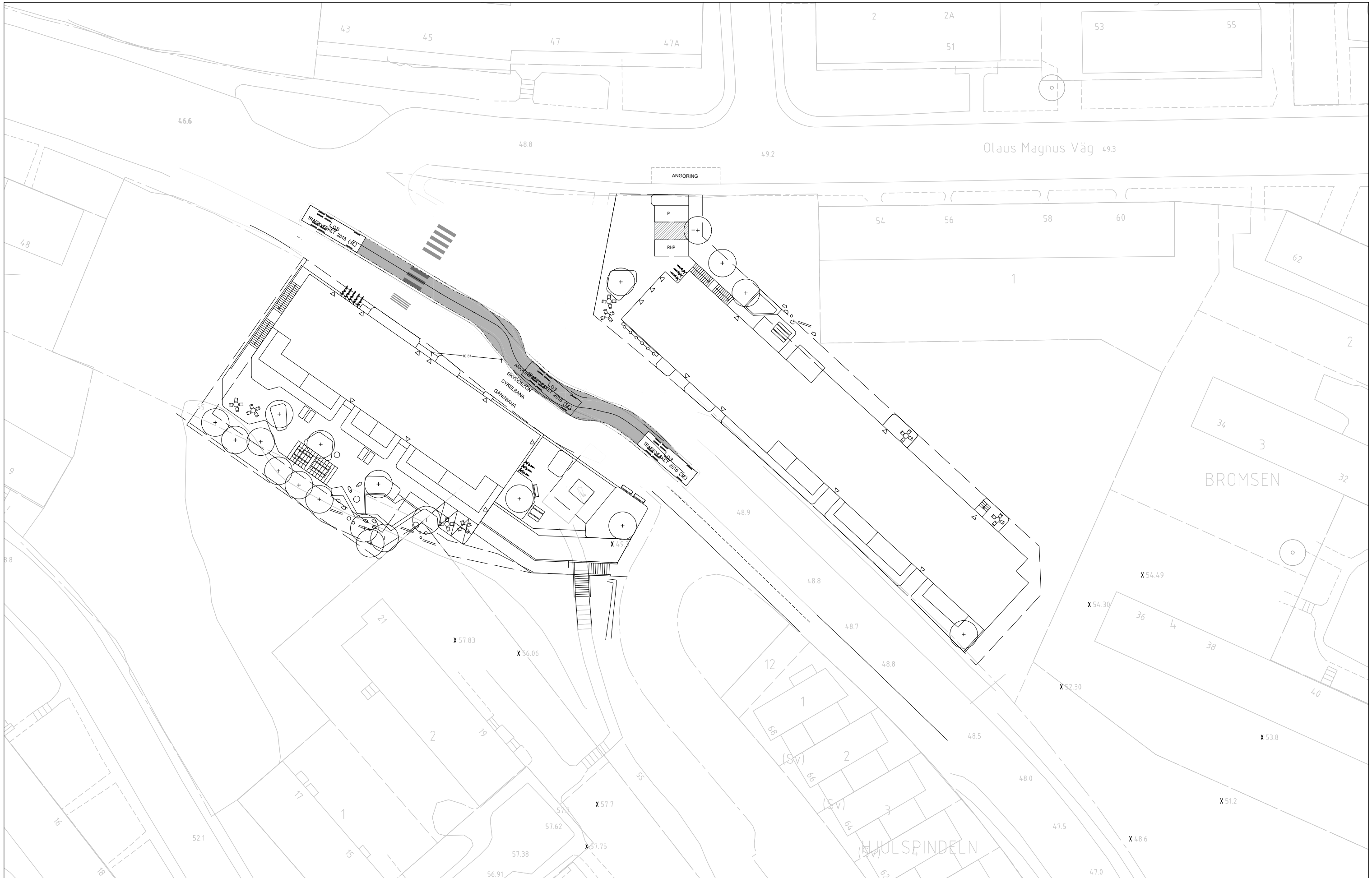

SPARRMANSBACKE
 SITUATIONSPLAN_ANGÖRING SPARRMANSVÄGEN_KÖRSPÅR Los
 20230511

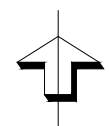

SKALA 1:500



Inkom till Stockholms stadsbyggnadskontor - 2023-09-06, Dnr 2021-14117

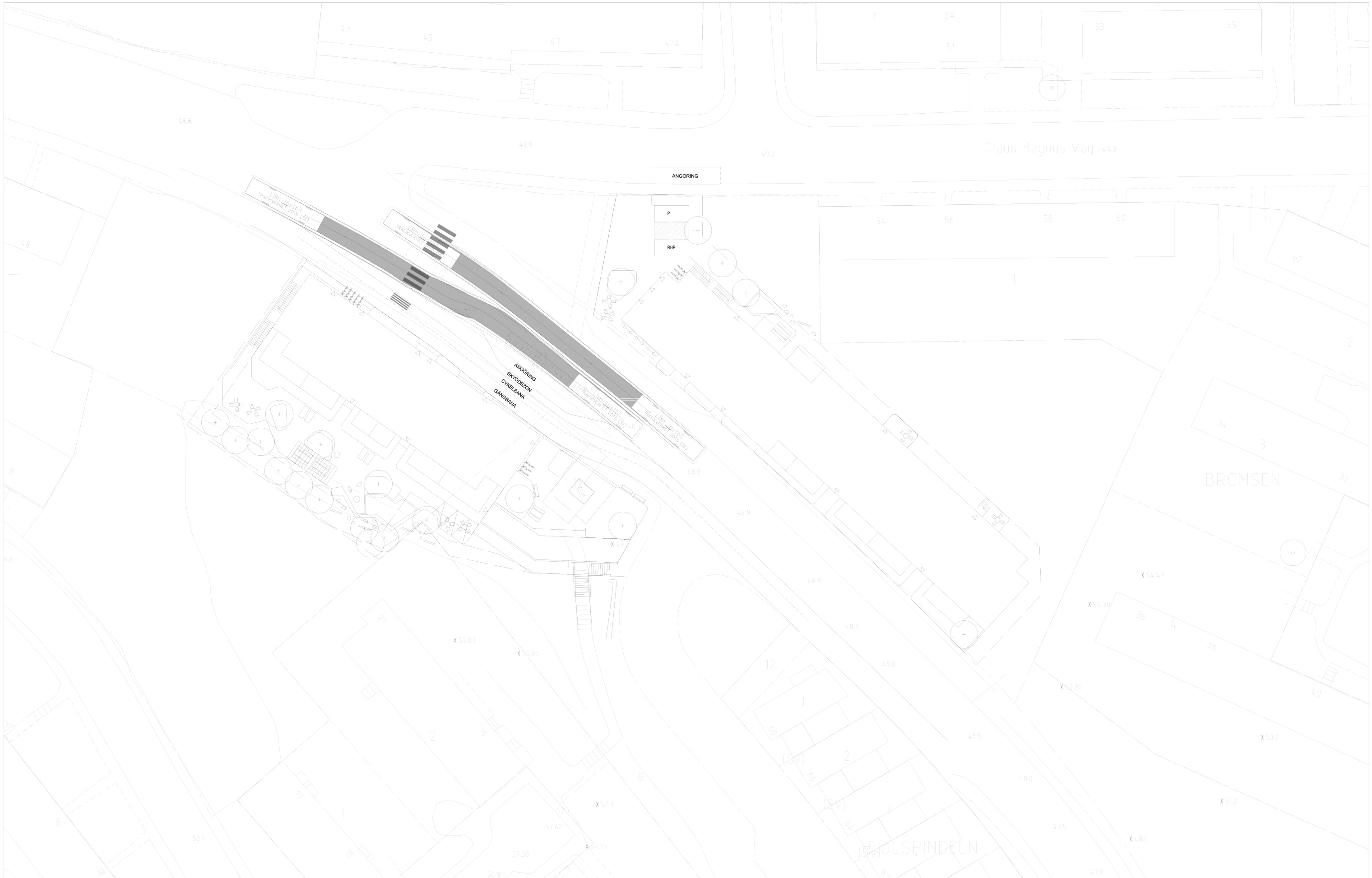

SPARRMANSBACKE

SITUATIONSPLAN_SPARRMANSVÄGEN_KÖRSPÅR LBN
20230511

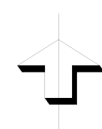

SKALA 1:500



Inkom till Stockholms stadsbyggnadskontor - 2023-09-06, Dnr 2021-14117

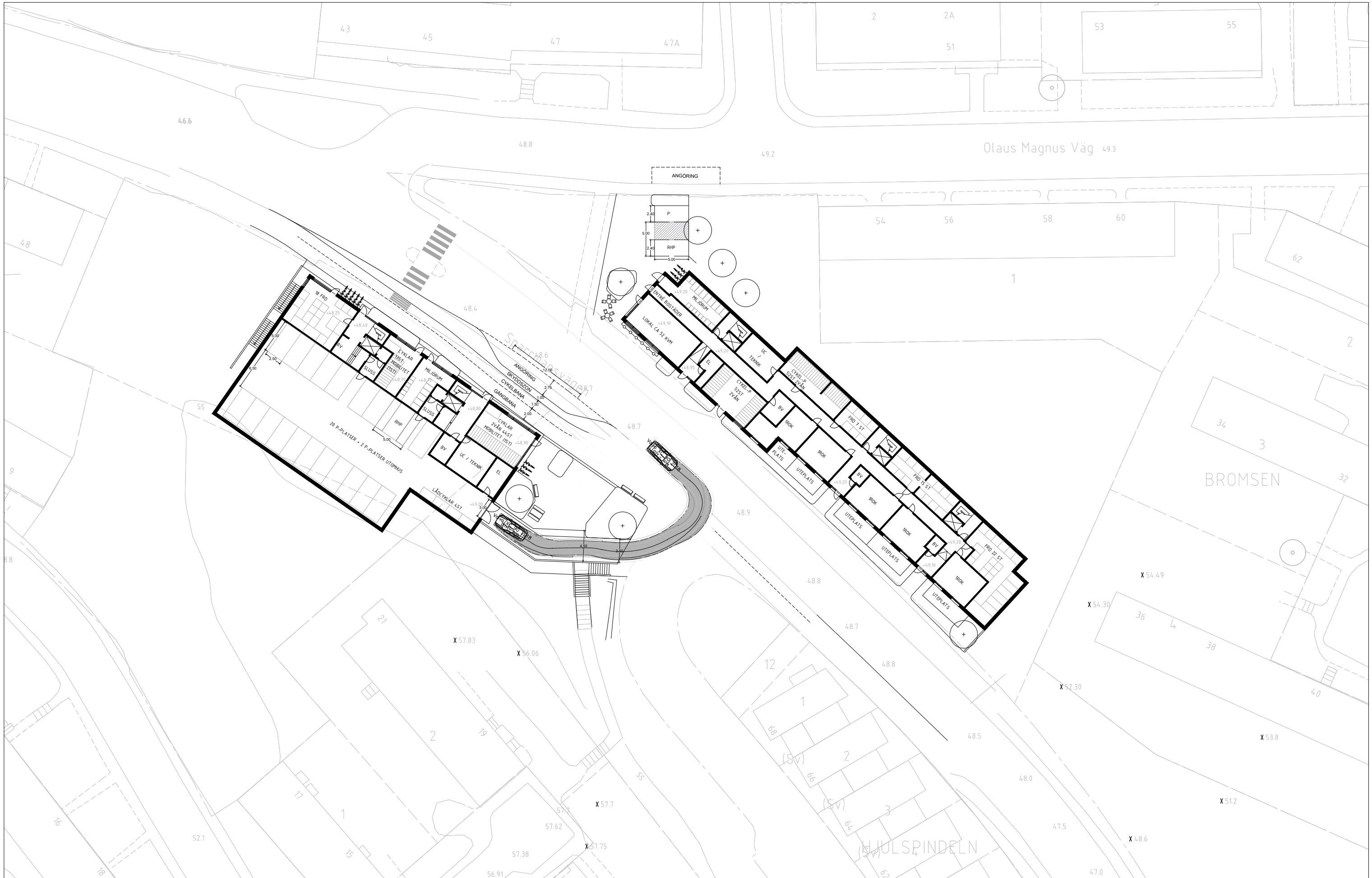

SPARRMANSBACKE
 SITUATIONSPLAN_ANGÖRING GARAGE_KÖRSPÅR Volvo XC 90
 20230511

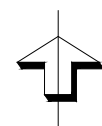

SKALA 1:500

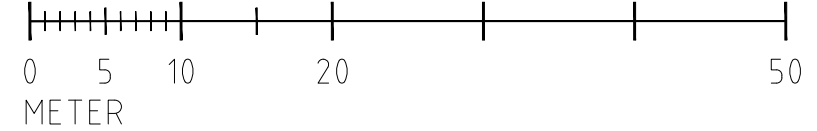

Inkom till Stockholms stadsbyggnadskontor - 2023-09-06, Dnr 2021-14117

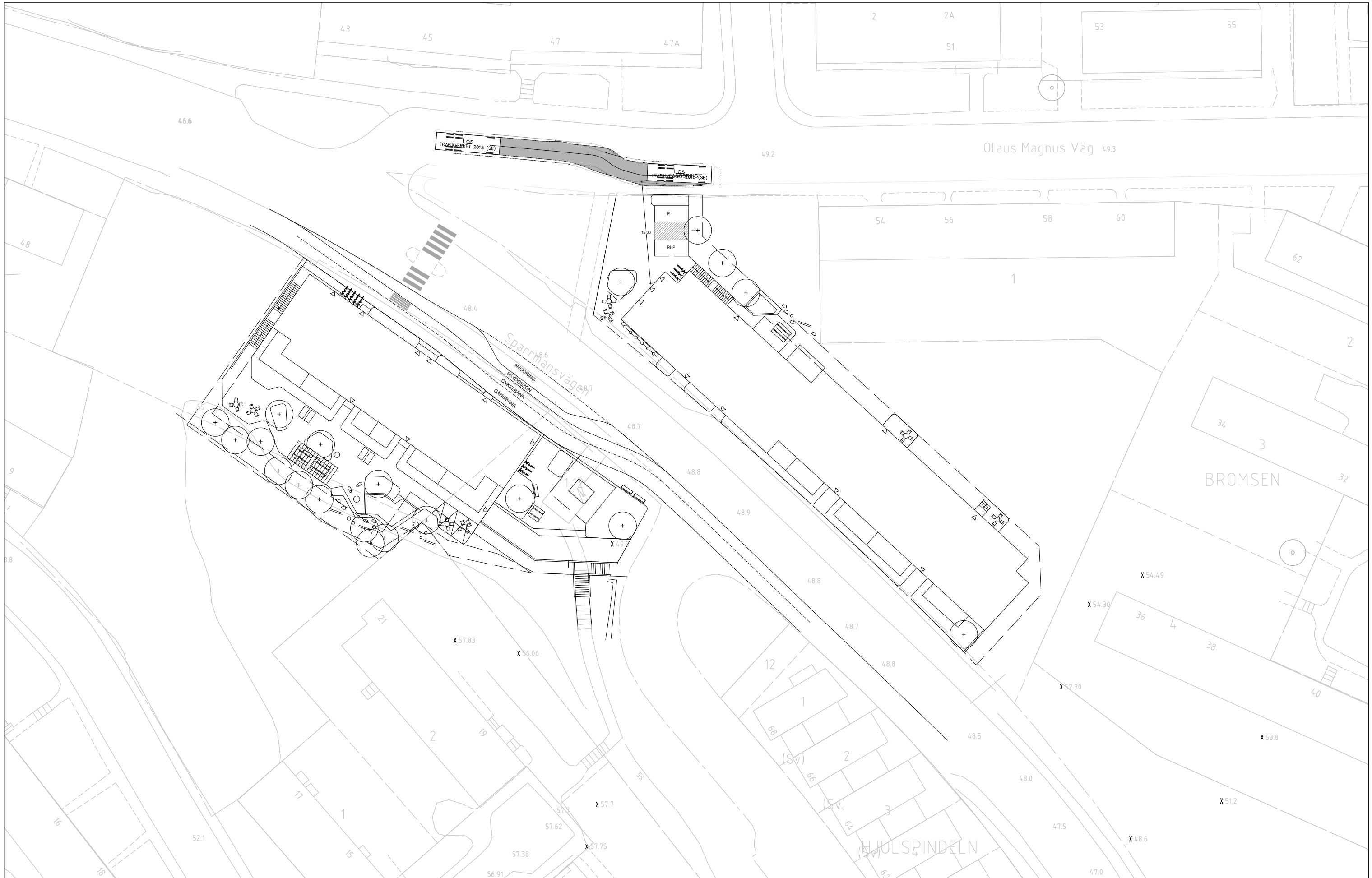

SPARRMANSBACKE
 SITUATIONSPLAN_ANGÖRING OLAUS MAGNUS VÄG_KÖRSPÅR Los
 20230511

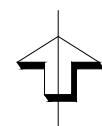

SKALA 1:500

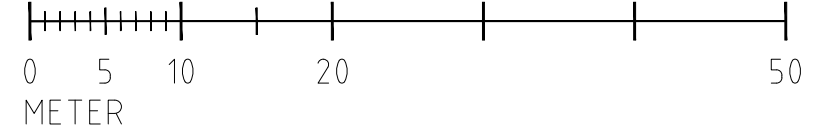

Inkom till Stockholms stadsbyggnadskontor - 2023-09-06, Dnr 2021-14117



SPARRMANSBACKE
 SITUATIONSPLAN_ANGÖRING P-PLATS OCH RHP_KÖRSPÅR Volvo XC 90_1
 20230511

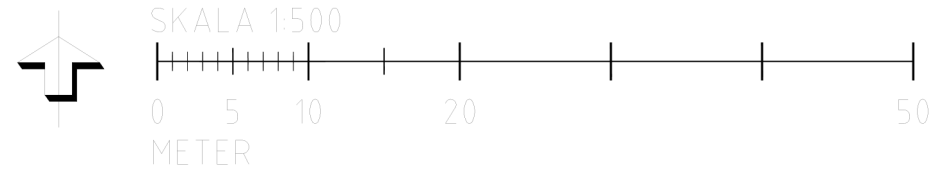

Inkom till Stockholms stadsbyggnadskontor - 2023-09-06, Dnr 2021-14117



SPARRMANSBACKE

SITUATIONSPLAN_ANGÖRING P-PLATS OCH RHP_KÖRSPÅR Volvo XC 90_2
20230511

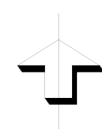

SKALA 1:500



Inkom till Stockholms stadsbyggnadskontor - 2023-09-06, Dnr 2021-14117